

# ST SERIES

## ST Series 105° Stainless Steel Soft Closing Concealed Hinge with Fixed Plate





### Specification

Opening Angle	105°
Function	Soft Close
Plate Type	Fixed Plate
Cup Depth	11.5 mm
Cup Diameter	35 mm
Drilling Distance	3 mm - 7 mm
Door Thickness	14 mm - 22 mm
Material	Stainless Steel 304
Height Adjustment Range	4 mm
Overlay Adjustment Range	6 mm
Depth Adjustment Range	5 mm
Finish	Stainless Steel
Packaging	100 Units per Carton

### Notable Features

- Stainless steel 304 body with brass damper for very high corrosion resistance.
- Ideal for installation in kitchens, bathrooms, beach houses and buildings in humid climates.
- 10 year warranty on function and rust resistance.

	<b>Full Overlay</b>		<b>Half Overlay</b>		<b>Inset</b>
<b>Code:</b> STN250F		<b>Code:</b> STN250H		<b>Code:</b> STN250S	

**Additional Options:** 1P - Individual Hinge, Caps for Arm and Cup, Mounting Plate and Screws in Sealed Bag  
2P - Pair of Hinges, Caps for Arm and Cup, Mounting Plates and Screws in Sealed Bag  
ND - No Damper

### Drilling For Cup

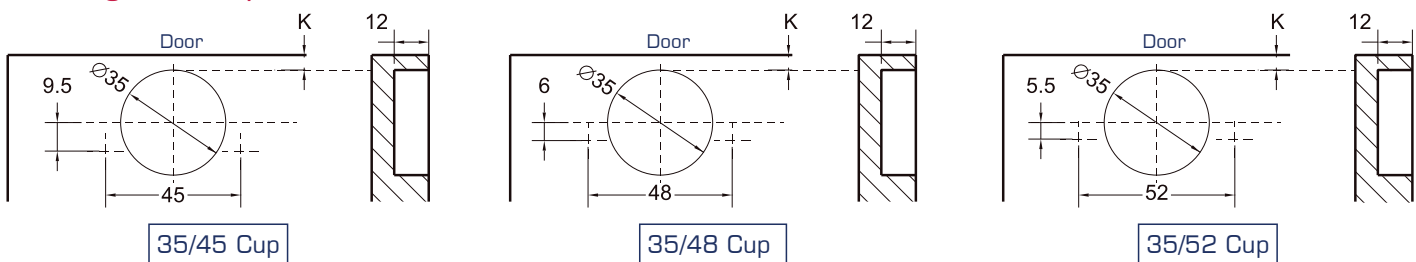

### Cup Installation

#### Screw-on

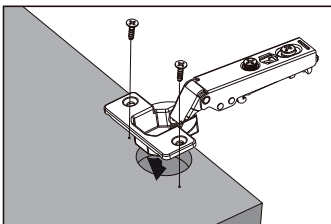

Installation Method	Code
Wood Screws	S2
Euro Screws	S4

#### Press-in

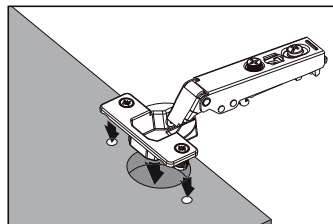

Installation Method	Code
8 mm Dowels	K5
10 mm Dowels	K6

## Overlay Table

### Full Overlay

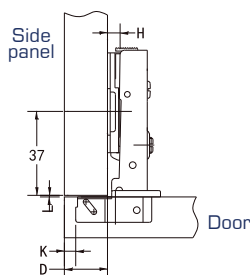

$$H = 14 + K - D$$

$\begin{matrix} D & K \\ H \end{matrix}$	3	4	5	6	7
0	17	18	19	20	21
2	15	16	17	18	19

### Half Overlay

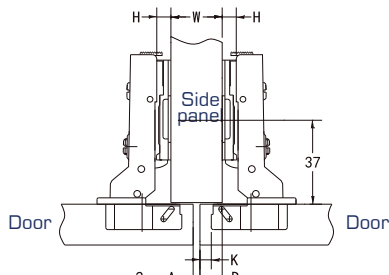

$$H = 4 + K - D$$

$\begin{matrix} D & K \\ H \end{matrix}$	3	4	5	6	7
0	7	8	9	10	11
2	5	6	7	8	9

### Inset

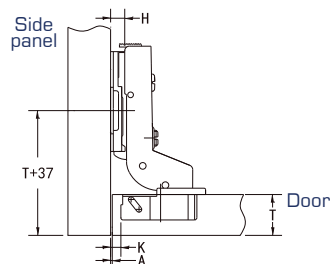

$$H = -4 + K + A$$

$\begin{matrix} A & K \\ H \end{matrix}$	3	4	5	6	7
0	1	0	-1	-2	-3
2	3	2	1	0	-1

## Minimum Reveal Table

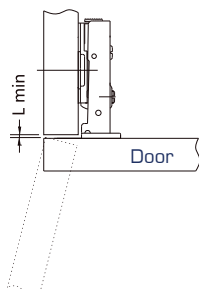
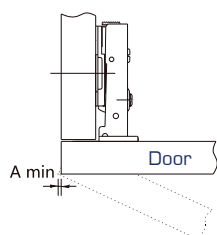

$\begin{matrix} A & K \\ T \end{matrix}$	14	15	16	17	18	19	20	21	22
3	0.3	0.5	0.7	0.9	1.2	1.5	1.8	2.2	2.6
4	0.3	0.5	0.7	0.9	1.1	1.4	1.8	2.1	2.5
5	0.2	0.4	0.6	0.9	1.1	1.4	1.7	2.0	2.4
6	0.2	0.4	0.6	0.8	1.1	1.3	1.6	2.0	2.4
7	0.2	0.4	0.5	0.8	1.0	1.3	1.6	1.9	2.3

$\begin{matrix} L & K \\ T \end{matrix}$	14	15	16	17	18	19	20	21	22
3	1.0	1.0	1.0	1.0	1.0	1.0	1.0	1.0	1.0
4	1.0	1.0	1.0	1.0	1.0	1.0	1.0	1.0	1.2
5	1.0	1.0	1.0	1.0	1.0	1.3	1.5	1.8	2.0
6	1.0	1.3	1.5	1.8	2.0	2.3	2.5	2.8	3.0
7	2.0	2.3	2.5	2.7	3.0	3.2	3.5	3.7	3.9

K = Boring distance

T = Door thickness

A = Minimum gap (A) for door with a door edge radius

L = Gap between door and panel

### Note:

The minimum parameters in the reveal tables are based on doors with straight, square edges. A rounded or beveled profile will change the minimum reveal required.

## Hinge Adjustment

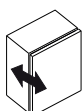
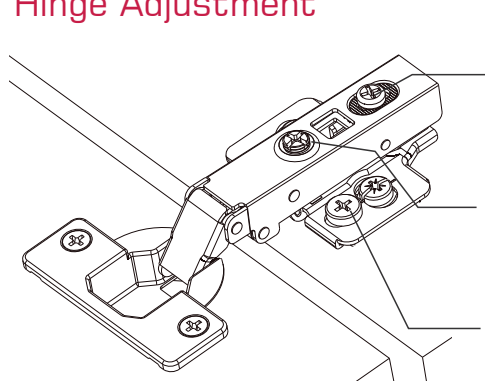

### Depth Adjustment

Move the hinge laterally to adjust door gap.

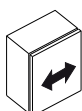

### Horizontal Adjustment

Rotate the hinge arm screw to increase or decrease door overlay.

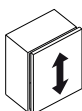

### Vertical Adjustment

Adjust the mounting plate to increase or decrease the door height.

### Note:

The referenced adjustment range described is the product design range. The actual design of the cabinet and the drilling method may have a certain impact on the parameters.