

LD SERIES

LD Series 95° One-way Soft Closing Concealed Hinge for Thick Doors (Cam Adjustable)



Specification

| | |
|---------------------------------|----------------------|
| Opening Angle | 95° |
| Function | Soft Close |
| Plate Type | Clip On |
| Cup Depth | 13.5 mm |
| Cup Diameter | 40 mm |
| Drilling Distance | 3 mm - 11 mm |
| Door Thickness | 18 mm - 30 mm |
| Material | Cold Rolled Steel |
| Height Adjustment Range | Plate Adjustment |
| Overlay Adjustment Range | 6 mm |
| Depth Adjustment Range | 3.8 mm |
| Finish | Copper Nickel |
| Packaging | 100 Units per Carton |

Notable Features

- Classic 40 mm cup design.



Additional Options: 1P - Individual Hinge, Caps for Arm and Cup, Mounting Plate and Screws in Sealed Bag
 ND - No Damper

Drilling For Cup

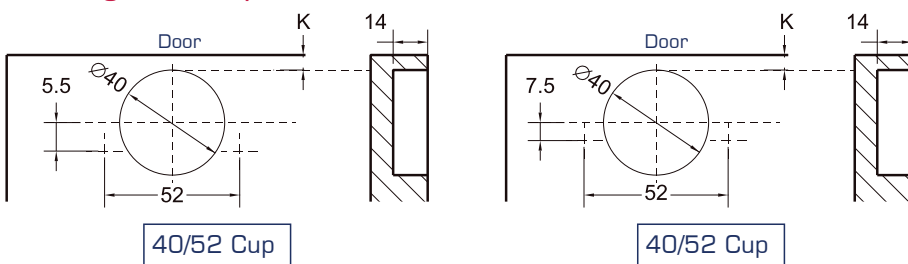

Cup Installation

Screw-on

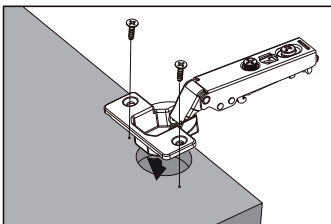

| Installation Method | Code |
|---------------------|------|
| Wood Screws | S2 |
| Euro Screws | S4 |

Press-in

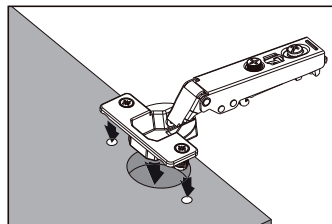

| Installation Method | Code |
|---------------------|------|
| 8 mm Dowels | K5 |
| 10 mm Dowels | K6 |

Overlay Table

Full Overlay

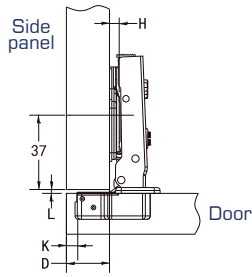

$$H = 18 + K - D$$

| D \ K | 3 | 4 | 5 | 6 | 7 | MAX=11 |
|-------|----|----|----|----|----|--------|
| 0 | 21 | 22 | 23 | 24 | 25 | ... |
| 2 | 19 | 20 | 21 | 22 | 23 | ... |
| 4 | 17 | 18 | 19 | 20 | 21 | ... |

Half Overlay

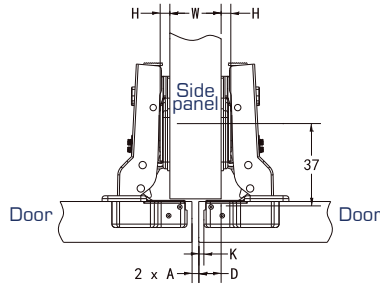

$$H = 10 + K - D$$

| D \ K | 3 | 4 | 5 | 6 | 7 | MAX=11 |
|-------|----|----|----|----|----|--------|
| 0 | 13 | 14 | 15 | 16 | 17 | ... |
| 2 | 11 | 12 | 13 | 14 | 15 | ... |
| 4 | 9 | 10 | 11 | 12 | 13 | ... |

Inset

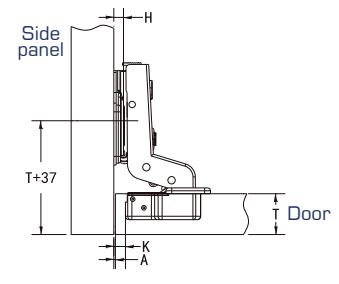

$$H = -4 + K + A$$

| A \ K | 3 | 4 | 5 | 6 | 7 |
|-------|---|---|----|----|----|
| 0 | 1 | 0 | -1 | -2 | -3 |
| 2 | 3 | 2 | 1 | 0 | -1 |
| 4 | 5 | 4 | 3 | 2 | 1 |

Minimum Reveal Table

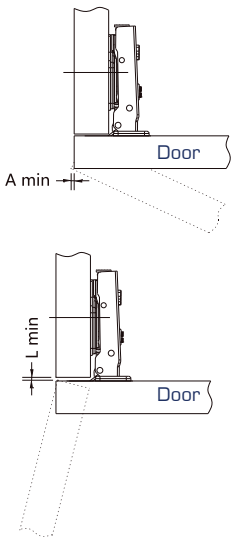

| A \ K | 18 | 19 | 20 | 21 | 22 | 23 | 24 | 25 | 26 | 27 | 28 | 29 | 30 |
|-------|-----|-----|-----|-----|-----|-----|-----|-----|-----|-----|-----|-----|-----|
| 3 | 0.0 | 0.1 | 0.5 | 0.8 | 1.1 | 1.5 | 1.8 | 2.2 | 2.5 | 2.8 | 3.2 | 3.5 | 3.9 |
| 4 | 0.0 | 0.0 | 0.4 | 0.7 | 1.1 | 1.4 | 1.8 | 2.1 | 2.4 | 2.8 | 3.1 | 3.5 | 3.8 |
| 5 | 0.0 | 0.0 | 0.3 | 0.7 | 1.0 | 1.4 | 1.7 | 2.0 | 2.4 | 2.7 | 3.1 | 3.4 | 3.8 |
| 6 | 0.0 | 0.0 | 0.3 | 0.6 | 1.0 | 1.3 | 1.6 | 2.0 | 2.3 | 2.7 | 3.0 | 3.3 | 3.7 |
| 7 | 0.0 | 0.0 | 0.2 | 0.6 | 0.9 | 1.2 | 1.6 | 1.9 | 2.3 | 2.6 | 2.9 | 3.3 | 3.6 |
| 8 | 0.0 | 0.0 | 0.2 | 0.5 | 0.9 | 1.2 | 1.5 | 1.9 | 2.3 | 2.6 | 2.9 | 3.3 | 3.6 |
| 9 | 0.0 | 0.0 | 0.1 | 0.5 | 0.9 | 1.2 | 1.5 | 1.8 | 2.2 | 2.5 | 2.8 | 3.2 | 3.5 |
| 10 | 0.0 | 0.0 | 0.1 | 0.4 | 0.9 | 1.2 | 1.5 | 1.7 | 2.2 | 2.5 | 2.8 | 3.2 | 3.5 |
| 11 | 0.0 | 0.0 | 0.0 | 0.3 | 0.7 | 1.0 | 1.3 | 1.7 | 2.0 | 2.4 | 2.7 | 3.0 | 3.4 |

| L \ K | 18 | 19 | 20 | 21 | 22 | 23 | 24 | 25 | 26 | 27 | 28 | 29 | 30 |
|-------|-----|-----|-----|-----|-----|-----|-----|-----|-----|-----|-----|-----|-----|
| 3 - 9 | 1.0 | 1.0 | 1.0 | 1.0 | 1.0 | 1.0 | 1.0 | 1.0 | 1.0 | 1.0 | 1.0 | 1.0 | 1.0 |
| 10 | 1.0 | 1.0 | 1.0 | 1.0 | 1.0 | 1.0 | 1.0 | 1.0 | 1.0 | 1.0 | 1.0 | 1.0 | 1.0 |
| 11 | 1.0 | 1.0 | 1.1 | 1.2 | 1.3 | 1.4 | 1.5 | 1.6 | 1.7 | 1.8 | 1.9 | 2.0 | 2.1 |

K = Boring distance

T = Door thickness

A = Minimum gap (A) for door with a door edge radius

L = Gap between door and panel

Note:

The minimum parameters in the reveal tables are based on doors with straight, square edges. A rounded or beveled profile will change the minimum reveal required.

Hinge Adjustment

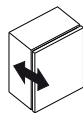
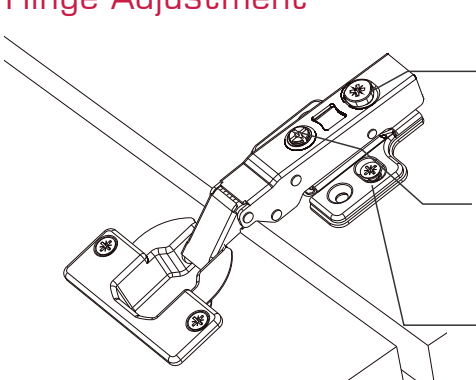

Depth Adjustment

Rotate the hinge arm cam to increase or decrease door gap.

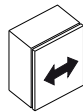

Horizontal Adjustment

Rotate the hinge arm screw to increase or decrease door overlay.

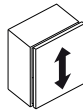

Vertical Adjustment

Adjust the mounting plate to increase or decrease the door height.

Note:

The referenced adjustment range described is the product design range. The actual design of the cabinet and the drilling method may have a certain impact on the parameters.

Plate Options: DS TS FP FS FM FN YD YS YT YP