

CV SERIES

CV Series 155° Zero Protrusion Soft Closing Concealed Hinge



Specification

Opening Angle	155°
Function	Soft Close
Plate Type	Clip On
Cup Depth	11.5 mm
Cup Diameter	35 mm
Drilling Distance	3 mm - 7 mm
Door Thickness	14 mm - 26 mm
Material	Cold Rolled Steel
Height Adjustment Range	Plate Adjustment
Overlay Adjustment Range	6 mm
Depth Adjustment Range	6 mm
Finish	Copper Nickel
Packaging	100 Units per Carton

Notable Features

- Wide opening angle to take optimal advantage of available storage space.
- Zero protrusion: When opened at 90°, the door does not protrude to block drawers or baskets from opening.
- Heavy duty product.

	Full Overlay		Half Overlay		Inset
Code: CVT210F		Code: CVT210H		Code: CVT210S	

Additional Options: 1P - Individual Hinge, Caps for Arm and Cup, Mounting Plate and Screws in Sealed Bag

Drilling For Cup

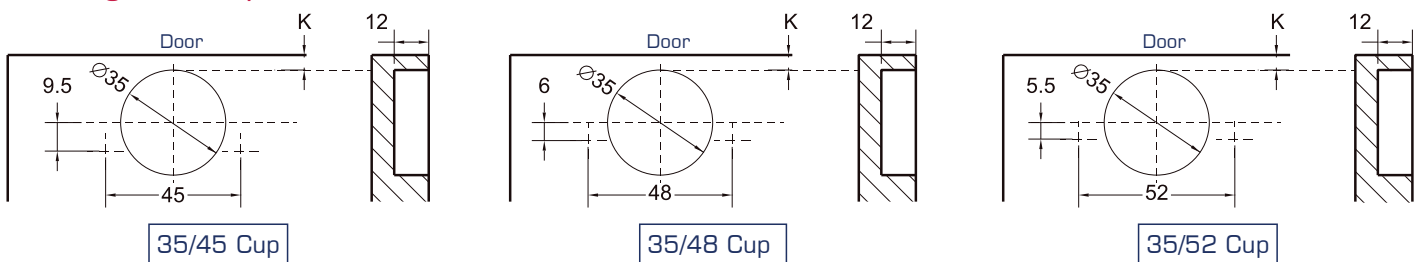

Cup Installation

Screw-on

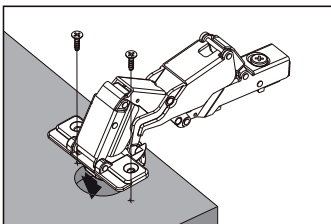

Installation Method
Wood Screws

Code
S2

Press-in

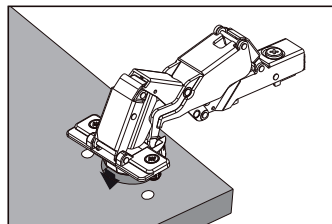

Installation Method
8 mm Dowels
10 mm Dowels

Code
K5
K6

Overlay Table

Full Overlay

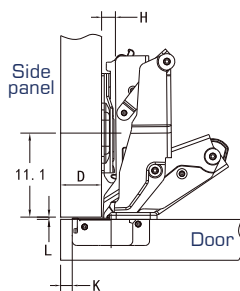

$$H = 14 + K - D$$

$\begin{matrix} D & K \\ H \end{matrix}$	3	4	5	6	7
0	17	18	19	20	21
2	15	16	17	18	19
4	13	14	15	16	17

Half Overlay

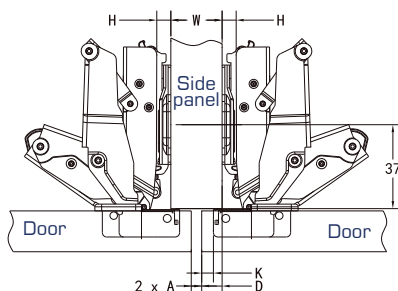

$$H = 4 + K - D$$

$\begin{matrix} D & K \\ H \end{matrix}$	3	4	5	6	7
0	7	8	9	10	11
2	5	6	7	8	9
4	3	4	5	6	7

Inset

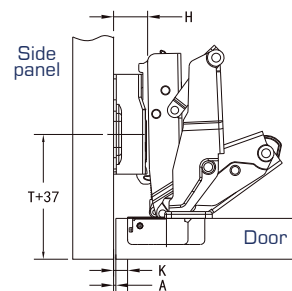

$$H = 5 + K + A$$

$\begin{matrix} A & K \\ H \end{matrix}$	3	4	5	6	7
9	1	0	-1	-2	-3

Minimum Reveal Table

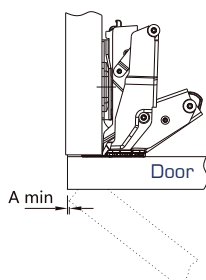

$\begin{matrix} A & K \\ T \end{matrix}$	14	15	16	17	18	19	20	21	22
3	0.0	0.0	0.0	0.0	0.0	0.0	0.0	0.0	0.0
4	0.0	0.0	0.0	0.0	0.0	0.0	0.0	0.0	0.0
5	0.0	0.0	0.0	0.0	0.0	0.0	0.0	0.0	0.0
6	0.0	0.0	0.0	0.0	0.0	0.0	0.0	0.0	0.0
7	0.0	0.0	0.0	0.0	0.0	0.0	0.0	0.0	0.0

K = Boring distance

T = Door thickness

A = Minimum gap (A) for door with a door edge radius

L = Gap between door and panel

Note:

The minimum parameters in the reveal tables are based on doors with straight, square edges. A rounded or beveled profile will change the minimum reveal required.

Hinge Adjustment

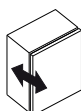
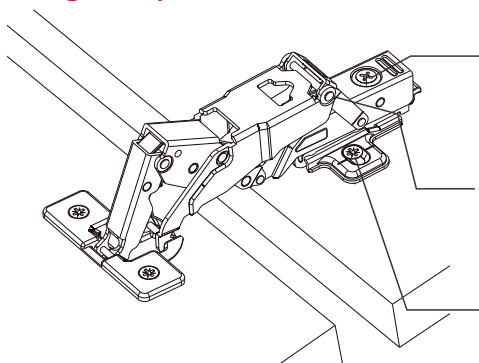

Depth Adjustment

Rotate the hinge arm cam to increase or decrease door gap.

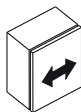

Horizontal Adjustment

Rotate the hinge arm screw to increase or decrease door overlay.

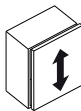

Vertical Adjustment

Adjust the mounting plate to increase or decrease the door height.

Note:

The referenced adjustment range described is the product design range. The actual design of the cabinet and the drilling method may have a certain impact on the parameters.

Plate Options: DS TS FP FS FM FN